

# VITI METRICHE TESTA ESAGONALE INOX A4-70 FILETTO PARZIALE

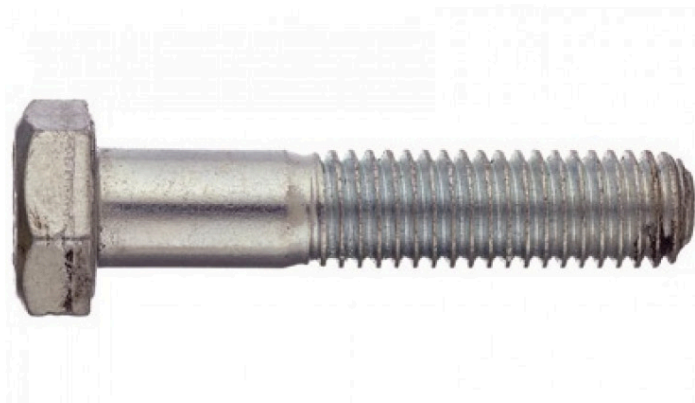

Viti metriche a testa esagonale parzialmente filettate

- A norma DIN 931
- In acciaio 8.8 grezzo (brunito)
- Passo grosso metrico MA
- Rottura > 700 N/mm<sup>2</sup>

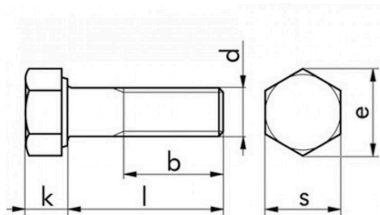

Ø	Lunghezza	Art.
m10	100	<b>F1095 10 100</b>
m10	110	<b>F1095 10 110</b>
m10	130	<b>F1095 10 130</b>
m10	140	<b>F1095 10 140</b>
m10	160	<b>F1095 10 160</b>
m10	170	<b>F1095 10 170</b>
m10	40	<b>F1095 10 40</b>
m10	45	<b>F1095 10 45</b>
m10	50	<b>F1095 10 50</b>
m10	55	<b>F1095 10 55</b>
m10	60	<b>F1095 10 60</b>
m10	65	<b>F1095 10 65</b>
m10	70	<b>F1095 10 70</b>
m10	75	<b>F1095 10 75</b>
m10	80	<b>F1095 10 80</b>
m10	90	<b>F1095 10 90</b>
m12	100	<b>F1095 12 100</b>
m12	110	<b>F1095 12 110</b>
m12	120	<b>F1095 12 120</b>
m12	130	<b>F1095 12 130</b>
m12	140	<b>F1095 12 140</b>
m12	160	<b>F1095 12 160</b>
m12	40	<b>F1095 12 40</b>
m12	45	<b>F1095 12 45</b>
m12	50	<b>F1095 12 50</b>
m12	55	<b>F1095 12 55</b>
m12	60	<b>F1095 12 60</b>
m12	65	<b>F1095 12 65</b>

# VITI METRICHE TESTA ESAGONALE INOX A4-70 FILETTO PARZIALE

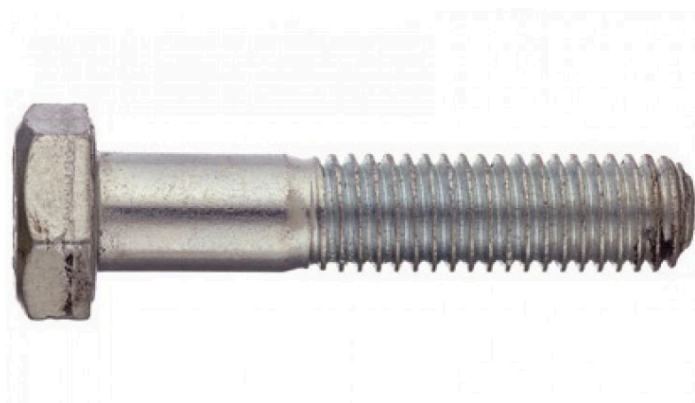

Viti metriche a testa esagonale parzialmente filettate

- A norma DIN 931
- In acciaio 8.8 grezzo (brunito)
- Passo grosso metrico MA
- Rottura > 700 N/mm<sup>2</sup>

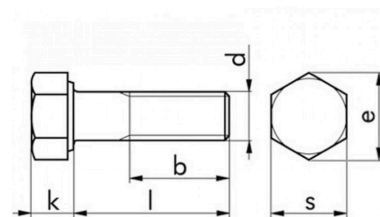

Ø	Lunghezza	Art.
m12	70	<b>F1095 12 70</b>
m12	80	<b>F1095 12 80</b>
m12	90	<b>F1095 12 90</b>
m14	100	<b>F1095 14 100</b>
m14	60	<b>F1095 14 60</b>
m14	70	<b>F1095 14 70</b>
m16	100	<b>F1095 16 100</b>
m16	110	<b>F1095 16 110</b>
m16	120	<b>F1095 16 120</b>
m16	130	<b>F1095 16 130</b>
m16	140	<b>F1095 16 140</b>
m16	150	<b>F1095 16 150</b>
m16	160	<b>F1095 16 160</b>
m16	180	<b>F1095 16 180</b>
m16	200	<b>F1095 16 200</b>
m16	50	<b>F1095 16 50</b>
m16	55	<b>F1095 16 55</b>
m16	60	<b>F1095 16 60</b>
m16	65	<b>F1095 16 65</b>
m16	70	<b>F1095 16 70</b>
m16	75	<b>F1095 16 75</b>
m16	80	<b>F1095 16 80</b>
m16	90	<b>F1095 16 90</b>
m20	100	<b>F1095 20 100</b>
m20	110	<b>F1095 20 110</b>
m20	120	<b>F1095 20 120</b>
m20	130	<b>F1095 20 130</b>
m20	140	<b>F1095 20 140</b>

# VITI METRICHE TESTA ESAGONALE INOX A4-70 FILETTO PARZIALE

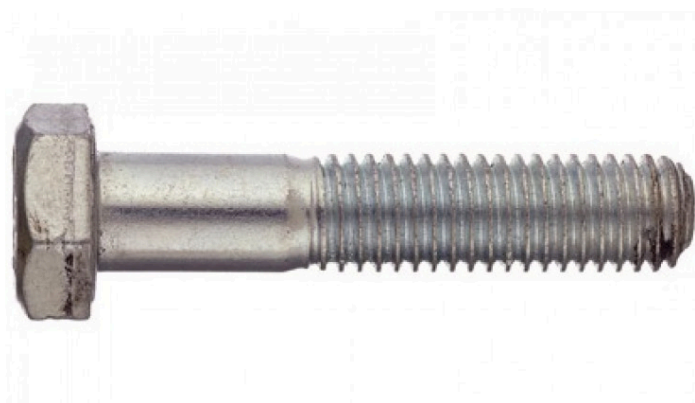

Viti metriche a testa esagonale parzialmente filettate

- A norma DIN 931
- In acciaio 8.8 grezzo (brunito)
- Passo grosso metrico MA
- Rottura > 700 N/mm<sup>2</sup>

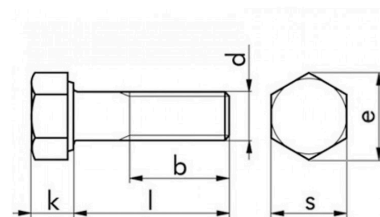

Ø	Lunghezza	Art.
m20	150	<b>F1095 20 150</b>
m20	160	<b>F1095 20 160</b>
m20	170	<b>F1095 20 170</b>
m20	180	<b>F1095 20 180</b>
m20	200	<b>F1095 20 200</b>
m20	60	<b>F1095 20 60</b>
m20	65	<b>F1095 20 65</b>
m20	70	<b>F1095 20 70</b>
m20	75	<b>F1095 20 75</b>
m20	80	<b>F1095 20 80</b>
m20	90	<b>F1095 20 90</b>
m24	100	<b>F1095 24 100</b>
m24	110	<b>F1095 24 110</b>
m24	120	<b>F1095 24 120</b>
m24	130	<b>F1095 24 130</b>
m24	160	<b>F1095 24 160</b>
m24	80	<b>F1095 24 80</b>
m24	90	<b>F1095 24 90</b>
m27	80	<b>F1095 27 80</b>
m30	120	<b>F1095 30 120</b>
m36	90	<b>F1095 36 90</b>
m5	30	<b>F1095 5 30</b>
m5	35	<b>F1095 5 35</b>
m5	40	<b>F1095 5 40</b>
m5	50	<b>F1095 5 50</b>
m6	30	<b>F1095 6 30</b>
m6	40	<b>F1095 6 40</b>
m6	45	<b>F1095 6 45</b>

RIPRODUZIONE VIETATA, anche parziale La Fine s.r.l. non assume responsabilità per eventuali inesattezze nel contenuto di questo prospetto e si riserva il diritto di apportare eventuali modifiche ritenute opportune.

# VITI METRICHE TESTA ESAGONALE INOX A4-70 FILETTO PARZIALE

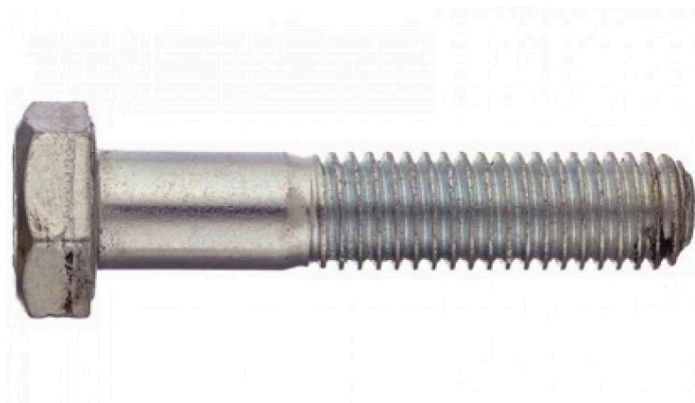

Viti metriche a testa esagonale parzialmente filettate

- A norma DIN 931
- In acciaio 8.8 grezzo (brunito)
- Passo grosso metrico MA
- Rottura > 700 N/mm<sup>2</sup>

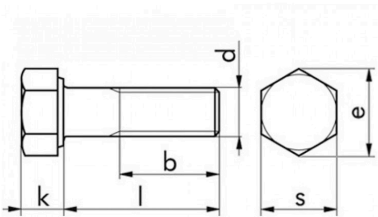

Ø	Lunghezza	Art.
m6	50	F1095 6 50
m6	60	F1095 6 60
m6	70	F1095 6 70
m8	100	F1095 8 100
m8	110	F1095 8 110
m8	120	F1095 8 120
m8	150	F1095 8 150
m8	40	F1095 8 40
m8	45	F1095 8 45
m8	50	F1095 8 50
m8	55	F1095 8 55
m8	60	F1095 8 60
m8	65	F1095 8 65
m8	70	F1095 8 70
m8	80	F1095 8 80
m8	90	F1095 8 90