

A close-up photograph of a metal screw, likely made of steel, showing its hexagonal head and threaded shaft. The screw is oriented horizontally against a plain white background. The head is on the left, and the threaded portion extends to the right. The threads are clearly visible and uniform. The surface of the metal has a slightly brushed or polished appearance with some minor reflections.

- A norma ISO 7380-2
- In acciaio inox A2
- Passo grosso metrico MA
- Interamente filettate

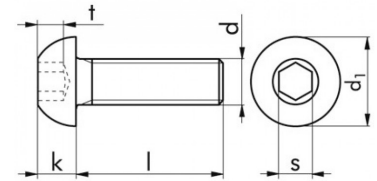

Ø	Lunghezza	Art.
m3	10	F2091 3 10
m3	12	F2091 3 12
m3	16	F2091 3 16
m3	20	F2091 3 20
m3	5	F2091 3 5
m3	6	F2091 3 6
m3	8	F2091 3 8
m4	10	F2091 4 10
m4	12	F2091 4 12
m4	16	F2091 4 16
m4	20	F2091 4 20
m4	25	F2091 4 25
m4	30	F2091 4 30
m4	6	F2091 4 6
m4	8	F2091 4 8
m5	10	F2091 5 10
m5	12	F2091 5 12
m5	16	F2091 5 16
m5	20	F2091 5 20
m5	25	F2091 5 25
m5	30	F2091 5 30
m5	35	F2091 5 35
m5	6	F2091 5 6
m5	8	F2091 5 8
m6	10	F2091 6 10
m6	12	F2091 6 12
m6	16	F2091 6 16
m6	20	F2091 6 20

RIPRODUZIONE VIETATA, anche parziale La Fine s.r.l. non assume responsabilità per eventuali inesattezze nel contenuto di questo prospetto e si riserva il diritto di apportare eventuali modifiche ritenute opportune.

VITI A TESTA CILINDRICA BOMB. FINTA ROND.

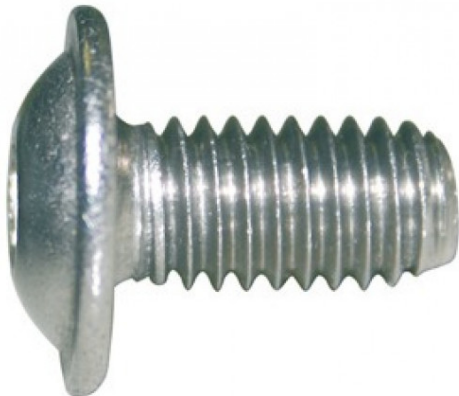

- Viti a testa cilindrica bombata con finta rondella sottotesta ed esagono incassato
- A norma ISO 7380-2
 - In acciaio inox A2
 - Passo grosso metrico MA
 - Interamente filettate

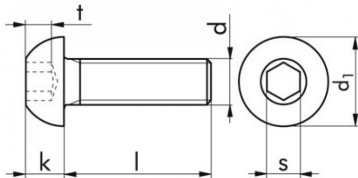

Ø	Lunghezza	Art.
m6	25	F2091 6 25
m6	30	F2091 6 30
m6	35	F2091 6 35
m6	40	F2091 6 40
m6	45	F2091 6 45
m6	50	F2091 6 50
m6	60	F2091 6 60
m6	8	F2091 6 8
m8	12	F2091 8 12
m8	16	F2091 8 16
m8	20	F2091 8 20
m8	25	F2091 8 25
m8	30	F2091 8 30
m8	35	F2091 8 35
m8	40	F2091 8 40
m8	50	F2091 8 50
m8	55	F2091 8 55
m8	60	F2091 8 60
m8	70	F2091 8 70