

GRANI PUNTA CONICA ESAGONO INCASSATO

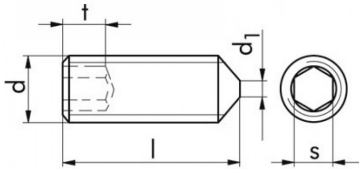

Grani a punta piana con esagono incassato

- A norma DIN 914
- In acciaio 45 H grezzo (brunito)
- Passo grosso metrico MA



Ø	Lunghezza	Art.
m 10	8	F0256 10 8
m 10	10	F0256 10 10
m 10	12	F0256 10 12
m 10	16	F0256 10 16
m 10	20	F0256 10 20
m 10	25	F0256 10 25
m 10	30	F0256 10 30
m 10	35	F0256 10 35
m 10	40	F0256 10 40
m 10	45	F0256 10 45
m 10	50	F0256 10 50
m 10	55	F0256 10 55
m 10	60	F0256 10 60
m 10	65	F0256 10 65
m 10	70	F0256 10 70
m 10	80	F0256 10 80
m 10	90	F0256 10 90
m 10	100	F0256 10 100
m 10	110	F0256 10 110
m 10	120	F0256 10 120
m 10	130	F0256 10 130
m 12	12	F0256 12 12
m 12	16	F0256 12 16
m 12	20	F0256 12 20
m 12	25	F0256 12 25
m 12	30	F0256 12 30
m 12	35	F0256 12 35
m 12	40	F0256 12 40

GRANI PUNTA CONICA ESAGONO INCASSATO



Grani a punta piana con esagono incassato

- A norma DIN 914
- In acciaio 45 H grezzo (brunito)
- Passo grosso metrico MA

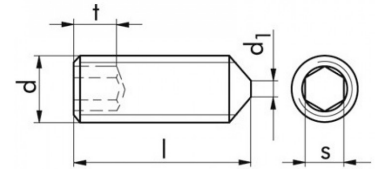

Ø	Lunghezza	Art.
m 12	45	F0256 12 45
m 12	50	F0256 12 50
m 12	60	F0256 12 60
m 12	70	F0256 12 70
m 12	80	F0256 12 80
m 12	90	F0256 12 90
m 12	100	F0256 12 100
m 14	20	F0256 14 20
m 14	30	F0256 14 30
m 16	16	F0256 16 16
m 16	20	F0256 16 20
m 16	25	F0256 16 25
m 16	30	F0256 16 30
m 16	35	F0256 16 35
m 16	40	F0256 16 40
m 16	45	F0256 16 45
m 16	50	F0256 16 50
m 16	60	F0256 16 60
m 16	70	F0256 16 70
m 16	80	F0256 16 80
m 20	20	F0256 20 20
m 20	25	F0256 20 25
m 20	30	F0256 20 30
m 20	35	F0256 20 35
m 20	40	F0256 20 40
m 20	45	F0256 20 45
m 20	50	F0256 20 50
m 20	60	F0256 20 60

GRANI PUNTA CONICA ESAGONO INCASSATO



Grani a punta piana con esagono incassato

- A norma DIN 914
- In acciaio 45 H grezzo (brunito)
- Passo grosso metrico MA

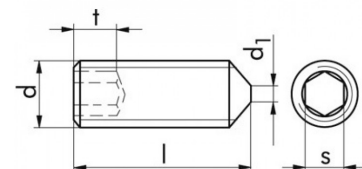

Ø	Lunghezza	Art.
m 20	70	F0256 20 70
m 20	80	F0256 20 80
m 20	100	F0256 20 100
m 20	120	F0256 20 120
m 20	140	F0256 20 140
m 24	40	F0256 24 40
m 24	50	F0256 24 50
m 24	60	F0256 24 60
m 24	70	F0256 24 70
m 24	80	F0256 24 80
m 24	90	F0256 24 90
m 24	100	F0256 24 100
m 3	4	F0256 3 4
m 3	5	F0256 3 5
m 3	6	F0256 3 6
m 3	8	F0256 3 8
m 3	10	F0256 3 10
m 3	12	F0256 3 12
m 3	16	F0256 3 16
m 3	20	F0256 3 20
m 3	25	F0256 3 25
m 4	6	F0256 4 6
m 4	8	F0256 4 8
m 4	10	F0256 4 10
m 4	12	F0256 4 12
m 4	16	F0256 4 16
m 4	20	F0256 4 20
m 4	25	F0256 4 25

GRANI PUNTA CONICA ESAGONO INCASSATO



Grani a punta piana con esagono incassato

- A norma DIN 914
- In acciaio 45 H grezzo (brunito)
- Passo grosso metrico MA

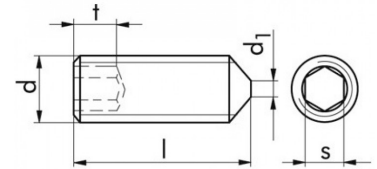

Ø	Lunghezza	Art.
m 4	30	F0256 4 30
m 5	10	F0256 5 10
m 5	12	F0256 5 12
m 5	16	F0256 5 16
m 5	20	F0256 5 20
m 5	25	F0256 5 25
m 5	30	F0256 5 30
m 5	35	F0256 5 35
m 5	40	F0256 5 40
m 5	50	F0256 5 50
m 6	18	F0256 6 18
m 6	20	F0256 6 20
m 6	25	F0256 6 25
m 6	30	F0256 6 30
m 6	35	F0256 6 35
m 6	40	F0256 6 40
m 6	45	F0256 6 45
m 6	50	F0256 6 50
m 6	55	F0256 6 55
m 8	12	F0256 8 12
m 8	16	F0256 8 16
m 8	20	F0256 8 20
m 8	25	F0256 8 25
m 8	30	F0256 8 30
m 8	35	F0256 8 35
m 8	40	F0256 8 40
m 8	45	F0256 8 45
m 8	50	F0256 8 50

GRANI PUNTA CONICA ESAGONO INCASSATO



Grani a punta piana con esagono incassato

- A norma DIN 914
- In acciaio 45 H grezzo (brunito)
- Passo grosso metrico MA

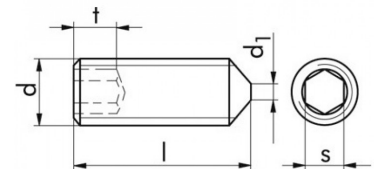

Ø	Lunghezza	Art.
m 8	60	F0256 8 60
m 8	70	F0256 8 70
m 8	80	F0256 8 80