

## RIVETTI A STRAPPO ALLUMINIO

Rivetti a strappo in alluminio

- A norma DIN 7337
- Occhiello in alluminio
- Chiodo in acciaio zincato

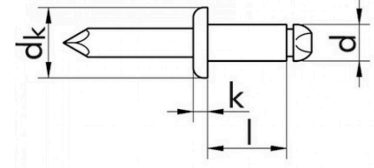

D	Dk	Ø Foro	Serraggio Min-Max	Carico Alla Trazione	Carico Al Taglio	L	Art.
2.4	5	2.5	0,5-1,0	45	35	4	<b>F3937 24 4</b>
2.4	5	2.5	0,5-3,0	45	35	6	<b>F3937 24 6</b>
2.4	5	2.5	3,0-5,0	45	35	8	<b>F3937 24 8</b>
3	6	3.1	1,0-3,0	90	65	6	<b>F3937 29 6</b>
3	6	3.1	2,0-4,0	90	65	7	<b>F3937 29 7</b>
3	6	3.1	3,0-5,0	90	65	8	<b>F3937 29 8</b>
3	6	3.1	5,0-7,0	90	65	10	<b>F3937 29 10</b>
3	6	3.1	7,0-9,0	90	65	12	<b>F3937 29 12</b>
3	6	3.1	9,0-11,0	90	65	14	<b>F3937 29 14</b>
3.2	6.5	3.3	1,0-3,0	100	70	6	<b>F3937 32 6</b>
3.2	6.5	3.3	3,0-5,0	100	70	8	<b>F3937 32 8</b>
3.2	6.5	3.3	5,0-7,0	100	70	10	<b>F3937 32 10</b>
3.2	6.5	3.3	7,0-9,0	100	70	12	<b>F3937 32 12</b>
3.2	6.5	3.3	8,0-11	100	70	14	<b>F3937 32 14</b>
3.2	6.5	3.3	11,0-13,0	100	70	16	<b>F3937 32 16</b>
3.4	7	3.5	2,0-4,0	110	75	7	<b>F3937 34 7</b>
3.4	7	3.5	4,0-6,0	110	75	9	<b>F3937 34 9</b>
3.4	7	3.5	7,0-9,0	110	75	12	<b>F3937 34 12</b>
3.4	7	3.5	9,0-11,0	110	75	14	<b>F3937 34 14</b>
4	8	4.1	3,5-4,5	185	130	8	<b>F3937 39 8</b>
4	8	4.1	5,5-6,5	185	130	10	<b>F3937 39 10</b>
4	8	4.1	7,5-8,5	185	130	12	<b>F3937 39 12</b>
4	8	4.1	8,5-10,5	185	130	14	<b>F3937 39 14</b>
4	8	4.1	10,5-12,5	185	130	16	<b>F3937 39 16</b>
4	8	4.1	12,5-14,5	185	130	18	<b>F3937 39 18</b>
4	8	4.1	14,5-16,5	185	130	20	<b>F3937 39 20</b>
4	8	4.1	24,5-26,5	185	130	30	<b>F3937 39 30</b>
4.8	10	5	5,0-6,0	304	223	10	<b>F3937 49 10</b>
4.8	10	5	7,0-8,0	304	223	12	<b>F3937 49 12</b>
4.8	10	5	8,0-10	304	223	14	<b>F3937 49 14</b>
4.8	10	5	10,0-12,0	304	223	16	<b>F3937 49 16</b>
4.8	10	5	12,0-14,0	304	223	18	<b>F3937 49 18</b>

## RIVETTI A STRAPPO ALLUMINIO

### Rivetti a strappo in alluminio

- A norma DIN 7337
- Occhiello in alluminio
- Chiodo in acciaio zincato

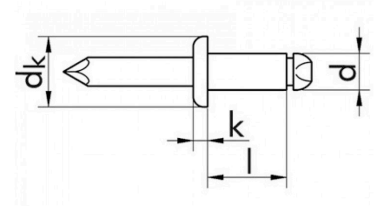

D	Dk	Ø Foro	Serraggio Min-Max	Carico Alla Trazione	Carico Al Taglio	L	Art.
4.8	10	5	14,0-16,0	304	223	20	<b>F3937 49 20</b>
4.8	10	5	16,0-18,0	304	223	22	<b>F3937 49 22</b>
4.8	10	5	24,0-26,0	304	223	30	<b>F3937 49 30</b>
5	9.5	5.2	1,5-3,0	304	223	6	<b>F3937 50 6</b>
5	9.5	5.2	3,0-4,5	304	223	8	<b>F3937 50 8</b>
5	9.5	5.2	4,5-6,0	304	223	10	<b>F3937 50 10</b>
5	9.5	5.2	6,0-8,0	304	223	12	<b>F3937 50 12</b>
5	9.5	5.2	8,0-10,0	304	223	14	<b>F3937 50 14</b>
5	9.5	5.2	10,0-12,0	304	223	16	<b>F3937 50 16</b>
5	9.5	5.2	12,0-14,0	304	223	18	<b>F3937 50 18</b>
5	9.5	5.2	12,5-17,0	304	223	20	<b>F3937 50 20</b>
5	9.5	5.2	17,0-20,5	304	223	24	<b>F3937 50 24</b>
6	12	6.1	3,0-5,0	433	280	10	<b>F3937 59 10</b>
6	12	6.1	5,0-7,0	433	280	12	<b>F3937 59 12</b>
6	12	6.1	7,0-10,0	433	280	15	<b>F3937 59 15</b>
6	12	6.1	10,0-13,0	433	280	18	<b>F3937 59 18</b>
6	12	6.1	12,0-14,0	433	280	20	<b>F3937 59 20</b>
6	12	6.1	13,0-17,0	433	280	22	<b>F3937 59 22</b>
6	12	6.1	9,0-11,0	433	280	16	<b>F3937 59 16</b>
6.4	12	6.5	7,0-10	632	380	15	<b>F3937 64 15</b>