

RIVETTI A STRAPPO ALLUMINIO VERNICIATO

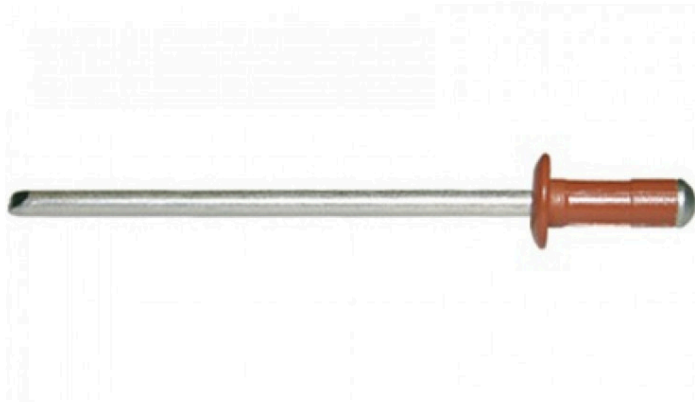

Rivetti a strappo in alluminio verniciato marrone rame

- Permette di serrare diversi spessori
- A norma DIN 7337
- Occhiello in alluminio
- Chiodo in acciaio inox A2

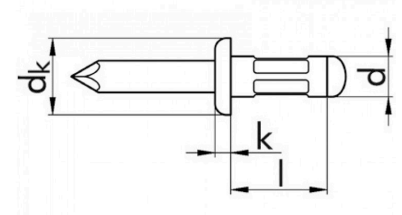

D Per Ø Fune	Lunghezza	Ø	Ø Foro	Ø Testa	Ral	Art.
0.8 - 4.8	8	3,2	3,3	6	marrone rame ral8004	F0916 32 83
1.2 - 6.5	10	4	4,1	8	marrone rame ral8004	F0916 4 103